

DRILL SERIES

Introducing...

The New Signature Series Drills
For The Aviation and Aerospace Industry



DRILL S E R I E S

Performance, Accuracy And Ergonomics...



Light weight aluminum housing



Ergonomic, handle with soft textured grip



Available in 1 HP and .6HP motor



3 planet gear system for increased life and load capacity



Teasing throttle, conveniently located reverse

Precision Tools for precise performance

Through next generation ergonomics and the continued focus on productivity and operator safety comes the development of the Sioux Tools Signature Series Drill line. Signature Series Drills are used throughout the military, commercial and private aerospace industry. The powerful five vane motor makes these drills great for drilling applications that contain ferrous and non-ferrous metals, wood and composite materials. The Signature Series Drills offer great value with a 3 planet gear system for increased life and load capacity. The Signature Drill has impressive runout of less than .005 inches @ 2 1/2" from the end of the chuck. The Sioux tools Signature Series Drill line reduces operator fatigue by offering a low sound level and low vibration solution! Operator comfort is achieved through the implementation of a light weight aluminum housing and a comfort grip. Drills are available in both reversing and non-reversing pistol grip and lever handle and configurations.

The Signature Series



Inspired by the operator, designed by Sioux Tools. Since 1914, Sioux Tools has been committed to bringing productive solutions to the pneumatic power tool industry.

Signature Series is an innovative pneumatic power tool program created through the implementation of next generation ergonomics, productivity enhanced features, serviceability, accuracy and value.

Through industry research and operator input, we have engineered a program that truly delivers tools for the way you work!





SDR10P26NK3



SDR10S26N3



SDR6P26N3



SDR10P25R3

Drills



Model Number	Free Speed	Chuck Capacity		Air Consumption		Sound Level	Spindle Thread
	rpm	in.	mm	scfm	l/s	dB(A)	
Pistol Grip Non-Reversing Drills (1.0 HP)							
SDR10P60N2	6,000	1/4	6	30	14.2	80	3/8"-24
SDR10P60N3	6,000	3/8	10	30	14.2	80	3/8"-24
SDR10P40N2	4,000	1/4	6	30	14.2	80	3/8"-24
SDR10P40N3	4,000	3/8	10	30	14.2	80	3/8"-24
SDR10P26N2	2,600	1/4	6	30	14.2	80	3/8"-24
SDR10P26N3	2,600	3/8	10	30	14.2	80	3/8"-24
SDR10P26N4	2,600	1/2	13	30	14.2	80	1/2"-20
SDR10P12N3	1,200	3/8	10	30	14.2	80	3/8"-24
SDR10P7N3	700	3/8	10	30	14.2	80	1/2"-20
SDR10P7N4	700	1/2	13	30	14.2	80	1/2"-20
SDR10P4N3	400	3/8	10	30	14.2	80	1/2"-20
SDR10P4N4	400	1/2	13	30	14.2	80	1/2"-20
Pistol Grip Non-Reversing Keyless Chuck Drills (1.0 HP) with Röhm Chucks							
SDR10P60NK3	6,000	3/8	10	30	14.2	80	3/8"-24
SDR10P40NK3	4,000	3/8	10	30	14.2	80	3/8"-24
SDR10P26NK3	2,600	3/8	10	30	14.2	80	3/8"-24
SDR10P26NK4	2,600	1/2	13	30	14.2	80	1/2"-20
SDR10P12NK3	1,200	3/8	10	30	14.2	80	3/8"-24
SDR10P7NK4	700	1/2	13	30	14.2	80	1/2"-20
SDR10P4NK4	400	1/2	13	30	14.2	80	1/2"-20
Pistol Grip Reversing Drills (1.0 HP)							
SDR10P40R2	4,000	1/4	6	30	14.2	80	3/8"-24
SDR10P40R3	4,000	3/8	10	30	14.2	80	3/8"-24
SDR10P25R2	2,500	1/4	6	30	14.2	80	3/8"-24
SDR10P25R3	2,500	3/8	10	30	14.2	80	3/8"-24
SDR10P20R2	2,000	1/4	6	30	14.2	80	3/8"-24
SDR10P20R3	2,000	3/8	10	30	14.2	80	3/8"-24
SDR10P20R4	2,000	1/2	13	30	14.2	80	1/2"-20
SDR10P7R3	700	3/8	10	30	14.2	80	3/8"-24
SDR10P7R4	700	3/8	10	30	14.2	80	1/2"-20
SDR10P5R3	500	3/8	10	30	14.2	80	1/2"-20
SDR10P5R4	500	1/2	13	30	14.2	80	1/2"-20
SDR10P3R3	300	3/8	10	30	14.2	80	1/2"-20
SDR10P3R4	300	1/2	13	30	14.2	80	1/2"-20
Inline Non-Reversing Drills (1.0 HP)							
SDR10S60N2	6,000	1/4	6	30	14.2	78	3/8"-24
SDR10S60N3	6,000	3/8	10	30	14.2	78	3/8"-24
SDR10S40N2	4,000	1/4	6	30	14.2	78	3/8"-24
SDR10S40N3	4,000	3/8	10	30	14.2	78	3/8"-24
SDR10S26N2	2,600	1/4	6	30	14.2	78	3/8"-24
SDR10S26N3	2,600	3/8	10	30	14.2	78	3/8"-24
SDR10S12N3	1,200	3/8	10	30	14.2	78	3/8"-24
SDR10S7N3	700	3/8	10	30	14.2	78	1/2"-20
SDR10S4N3	400	3/8	10	30	14.2	78	1/2"-20
SDR10S4N4	400	1/2	13	30	14.2	78	1/2"-20



Drills Continued

Model Number	Free Speed	Chuck Capacity		Air Consumption		Sound Level	Spindle Thread
	rpm	in.	mm	scfm	l/s	dB(A)	
Pistol Grip Non-Reversing Drills (0.6 HP)							
SDR6P60N2	6,000	1/4	6	25	11.8	80	3/8"-24
SDR6P60N3	6,000	3/8	10	25	11.8	80	3/8"-24
SDR6P40N2	4,000	1/4	6	25	11.8	80	3/8"-24
SDR6P40N3	4,000	3/8	10	25	11.8	80	3/8"-24
SDR6P26N2	2,600	1/4	6	25	11.8	80	3/8"-24
SDR6P26N3	2,600	3/8	10	25	11.8	80	3/8"-24
SDR6P26N4	2,600	1/2	13	25	11.8	80	1/2"-20
SDR6P12N3	1,200	3/8	10	25	11.8	80	3/8"-24
SDR6P7N3	700	3/8	10	25	11.8	80	1/2"-20
SDR6P7N4	700	1/2	13	25	11.8	80	1/2"-20
SDR6P4N3	400	3/8	10	25	11.8	80	1/2"-20
SDR6P4N4	400	1/2	13	25	11.8	80	1/2"-20
Pistol Grip Non-Reversing Keyless Chuck Drills (0.6 HP) with RöhM Chucks							
SDR6P60NK3	6,000	3/8	10	25	11.8	80	3/8"-24
SDR6P40NK3	4,000	3/8	10	25	11.8	80	3/8"-24
SDR6P26NK3	2,600	3/8	10	25	11.8	80	3/8"-24

Signature Series Drill Features

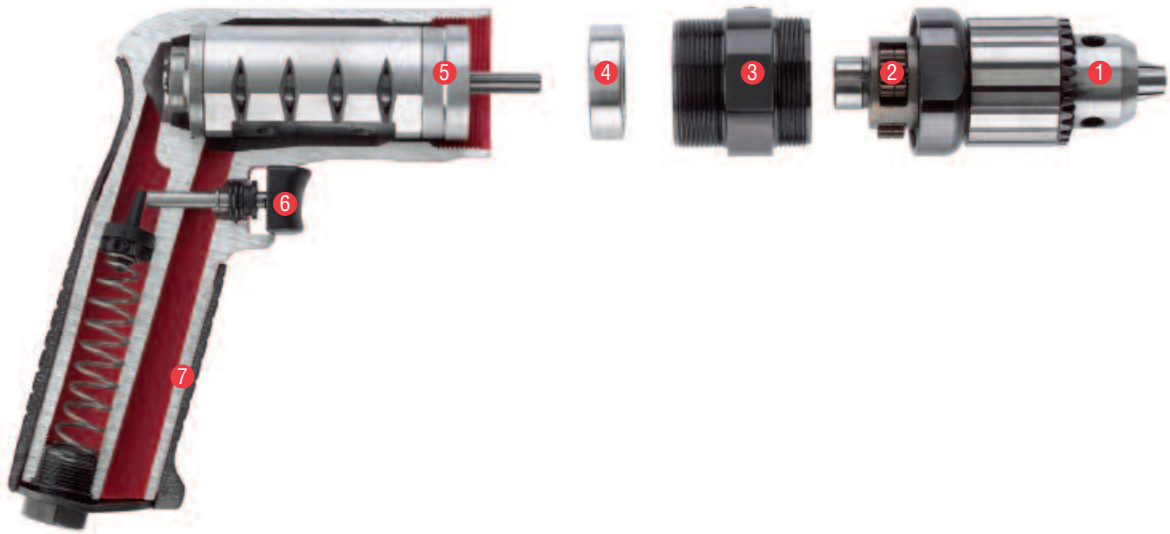

- 1 Available keyed or keyless chuck
- 3 Ring gear
- 6 Teasing throttle
- 2 3 planet gear system for increased life and load capacity
- 4 Ball bearing construction throughout
- 7 Cast aluminum handle with comfort grip
- 5 Precision machined steel motor

Serviceability

- Ring gear is machined into the motor retainer for ease of assembly and disassembly.
- Planetary gear reduction assembly can be serviced without removing the chuck.
- Rotor pinion is case hardened to resist wear.
- Rotor, cylinder and endplates are interchangeable between different models. This reduces the number of spare parts tool cribs need to stock.
- Tipper valve and valve seat are easily accessible for service.

Runout

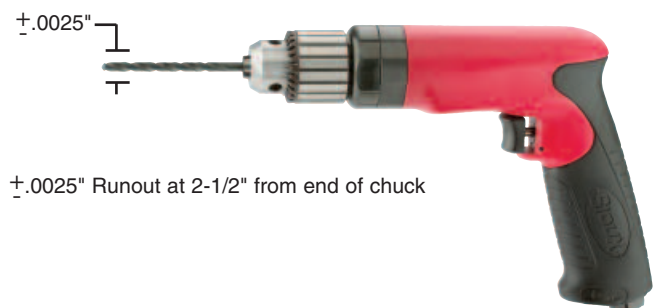

Signature Series Drill Dimensions

Model Number	A		B		C		D		Weight	
	in.	mm	in.	mm	in.	mm	in.	mm	lb	kg
Pistol Grip Non-Reversing Drills (1.0 HP)										
SDR10P60N2	6.5	165	7.6	193	5.7	145	1.6	41	2.31	1.05
SDR10P60N3	7.0	178	8.1	206	5.7	145	1.6	41	2.45	1.11
SDR10P40N2	6.5	165	7.6	193	5.7	145	1.6	41	2.31	1.05
SDR10P40N3	7.0	178	8.1	206	5.7	145	1.6	41	2.45	1.11
SDR10P26N2	6.5	165	7.6	193	5.7	145	1.6	41	2.31	1.05
SDR10P26N3	7.0	178	8.1	206	5.7	145	1.6	41	2.45	1.11
SDR10P26N4	7.5	191	8.6	218	5.7	145	1.6	41	2.90	1.31
SDR10P12N3	8.0	203	9.1	231	5.7	145	1.6	41	2.88	1.30
SDR10P7N3	8.0	203	9.1	231	5.7	145	1.6	41	2.88	1.30
SDR10P7N4	8.5	216	9.6	244	5.7	145	1.6	41	3.33	1.51
SDR10P4N3	8.0	203	9.1	231	5.7	145	1.6	41	2.88	1.30
SDR10P4N4	8.5	216	9.6	244	5.7	145	1.6	41	3.33	1.51
Pistol Grip Reversing Drills (1.0 HP)										
SDR10P40R2	7.1	180	8.2	208	5.7	145	1.6	41	2.42	1.10
SDR10P40R3	7.6	193	8.7	221	5.7	145	1.6	41	2.56	1.16
SDR10P25R2	7.1	180	8.2	208	5.7	145	1.6	41	2.42	1.10
SDR10P25R3	7.6	193	8.7	221	5.7	145	1.6	41	2.56	1.16
SDR10P20R2	7.1	180	8.2	208	5.7	145	1.6	41	2.42	1.10
SDR10P20R3	7.6	193	8.7	221	5.7	145	1.6	41	2.56	1.16
SDR10P20R4	7.9	201	9.0	227	5.7	145	1.6	41	3.01	1.37
SDR10P7R3	8.6	218	9.7	246	5.7	145	1.6	41	3.12	1.47
SDR10P7R4	9.1	231	10.2	259	5.7	145	1.6	41	3.57	1.62
SDR10P5R3	8.6	218	9.7	246	5.7	145	1.6	41	3.12	1.47
SDR10P5R4	9.1	231	10.2	259	5.7	145	1.6	41	3.57	1.62
SDR10P3R3	8.6	218	9.7	246	5.7	145	1.6	41	3.12	1.47
SDR10P3R4	9.1	231	10.2	259	5.7	145	1.6	41	3.57	1.62
Pistol Grip Non-Reversing Keyless Chuck Drills (1.0 HP) with Röhm Chucks										
SDR10P60NK3	7.6	195	8.7	220	5.7	145	1.6	41	2.85	1.30
SDR10P40NK3	7.6	195	8.7	220	5.7	145	1.6	41	2.85	1.30
SDR10P26NK3	7.6	195	8.7	220	5.7	145	1.6	41	2.85	1.30
SDR10P26NK4	8.1	205	9.2	235	5.7	145	1.6	41	3.15	1.40
SDR10P12NK3	8.6	220	9.7	245	5.7	145	1.6	41	3.30	1.50
SDR10P7NK4	9.1	230	10.2	260	5.7	145	1.6	41	3.55	1.60
SDR10P4NK4	9.1	230	10.2	260	5.7	145	1.6	41	3.55	1.60

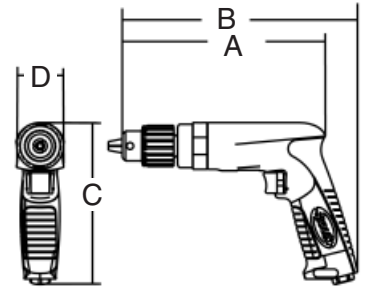

Model Number	A		B		Weight	
	in.	mm	in.	mm	lb	kg
Inline Non-Reversing Drills (1.0 HP)						
SDR10S60N2	1.6	40.6	7.8	198	2.18	0.99
SDR10S60N3	1.6	40.6	8.3	211	2.32	1.05
SDR10S40N2	1.6	40.6	7.8	198	2.18	0.99
SDR10S40N3	1.6	40.6	8.3	211	2.32	1.05
SDR10S26N2	1.6	40.6	7.8	198	2.18	0.99
SDR10S26N3	1.6	40.6	8.3	211	2.32	1.05
SDR10S12N3	1.6	40.6	9.3	236	2.75	1.25
SDR10S7N3	1.6	40.6	9.3	236	2.75	1.25
SDR10S4N3	1.6	40.6	9.3	236	2.75	1.25
SDR10S4N4	1.6	40.6	9.8	249	3.2	1.45

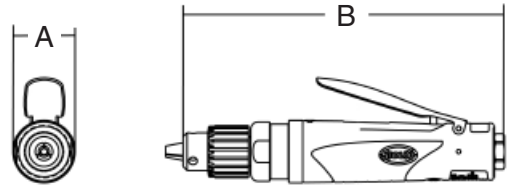

Model Number	A		B		C		D		Weight	
	in.	mm	in.	mm	in.	mm	in.	mm	lb	kg
Pistol Grip Non-Reversing Drills (0.6 HP)										
SDR6P60N2	5.8	147	6.9	175	5.7	145	1.6	41	2.12	0.96
SDR6P60N3	6.3	160	7.4	188	5.7	145	1.6	41	2.26	1.03
SDR6P40N2	5.8	147	6.9	175	5.7	145	1.6	41	2.12	0.96
SDR6P40N3	6.3	160	7.4	188	5.7	145	1.6	41	2.26	1.03
SDR6P26N2	5.8	147	6.9	175	5.7	145	1.6	41	2.12	0.96
SDR6P26N3	6.3	160	7.4	188	5.7	145	1.6	41	2.26	1.03
SDR6P26N4	6.6	168	7.7	196	5.7	145	1.6	41	2.71	1.23
SDR6P12N3	7.3	185	8.4	213	5.7	145	1.6	41	2.68	1.22
SDR6P7N3	7.3	185	8.4	213	5.7	145	1.6	41	2.68	1.22
SDR6P7N4	7.8	198	8.9	227	5.7	145	1.6	41	3.13	1.42
SDR6P4N3	7.3	185	8.4	213	5.7	145	1.6	41	2.68	1.22
SDR6P4N4	7.8	198	8.9	227	5.7	145	1.6	41	3.13	1.42
Pistol Grip Non-Reversing Keyless Chuck Drills (0.6 HP) with Röhm Chucks										
SDR6P60NK3	6.9	175	8.0	200	5.7	145	1.6	41	2.45	1.10
SDR6P40NK3	6.9	175	8.0	200	5.7	145	1.6	41	2.45	1.10
SDR6P26NK3	6.9	175	8.0	200	5.7	145	1.6	41	2.45	1.10

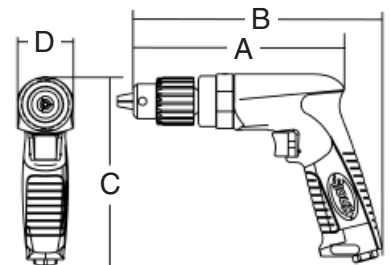



siouxtools.com



250 Snap-on Drive
P.O. Box 1596
Murphy, North Carolina USA 28906
PH: 828.835.9765
FAX: 828.835.9685
TOLL FREE: 866.259.7291
TOLL FREE FAX: 800.722.7236

Benelux
Tel.: (N) 31 (0) 20 568 26 63
(B) 32 (0) 14 23 19 67
Fax: (N) 31 (0) 20 568 26 60
(B) 31 (0) 14 23 26 27
e-mail: snap@snap-on.nl

Latin America
Tel.: 305-271-0944
Fax: 305-271-7152
e-mail: latinamerica.caribbean@snapon.com

Germany
Tel.: 49 2104 9509-0
Fax: 49 2104 9509-99
e-mail: snapon.industrial@snapon.com

Italy
Tel.: 00 39 02 66 04 53 70
Fax: 00 39 02 61 29 78 15
e-mail: indus.italia@snapon.com

United Kingdom
Tel.: 44 (0) 1536-413904
Fax: 44 (0) 1536-413874
e-mail: industrialuk@snapon.com

Asia
Tel.: 65-6451-5570
Fax: 65-6451-5574
email: esales.sg@snapon.com

Australia
Tel.: 61 2 9837 9100
Fax: 61 2 9624 2578
e-mail: SOTA.customerservice@snapon.com

Distributed By:

